

H-179

MINI STRUT

Page 1 of 2

$\frac{13}{16}" \times \frac{13}{16}"$

19 Gauge Channel
wt./100 ft. - 40#

Stocked in pre-galvanized, plain, & powder coated Supr-Green in 10 ft. lengths. Other materials, finishes & lengths are available upon request.

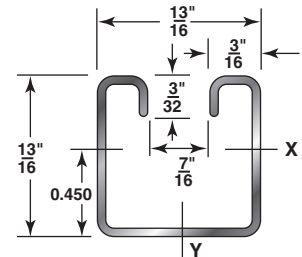
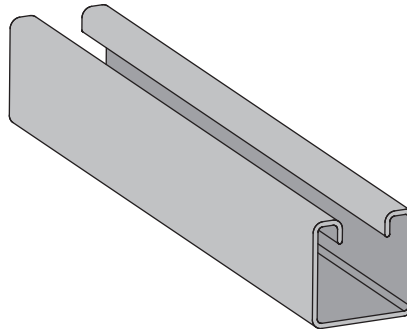

Specifications

GENERAL

H-STRUT channels are manufactured by a series of forming dies, or rolls, which progressively cold work the strip steel into the desired channel configuration. This method produces a cross section of uniform dimensions within a tolerance of plus or minus 0.015", on outside dimensions.

LENGTH INFORMATION

H-STRUT Channels are produced and stocked in 10' and 20' lengths with a tolerance of $\pm \frac{1}{8}"$. Other lengths are available upon request.

LOADING DATA

1. When calculating load at center of span, multiply load from table by 0.5 and deflection by 0.8.
2. When calculating beam and column loads for aluminum, multiply by 33%.

MATERIAL

H-STRUT channels are produced from prime structural steel covered by the following specifications. (See technical section for additional information)

- ☐ Pre-Galvanized SteelASTM A-653
 - ☐ Plain SteelASTM A-1011-04-SS
 - ☐ Aluminum (Type 6063T6)ASTM B-221
 - ☐ Stainless Steel (Type 304 & 316) . .ASTM A-240
- Other materials and specifications available on request.

FINISHES

All H-STRUT channels are stocked in pre-galvanized and powder coated Supr-Green. Some sizes are stocked in zinc trivalent chromium, PVC or hot dipped galvanized.

- ☐ Hot Dipped Galvanized.ASTM A-123
- ☐ Zinc Trivalent Chromium.ASTM B-633-85
- ☐ Powder Coated Supr-Green. . . .ASTM B-117
- ☐ PVC Coating 40 ML Thickness - Available Upon Request

H-179

 $\frac{13}{16}" \times \frac{13}{16}"$
19 Gauge Channel
wt./100 ft. - 40#
(Cont.)

Page 2 of 2

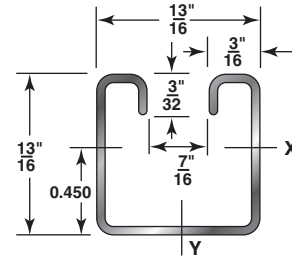

SECTION PROPERTIES

Catalog No.	Wt./Ft. Lbs.	Area of Section Sq. In.	X-X Axis			Y-Y Axis		
			I in ⁴	S in ³	r in.	I in ⁴	S in ³	r in.
H-179	0.40	0.1076	0.009	0.020	0.292	0.012	0.029	0.332

I = Moment of Inertia S = Section Modulus r = Radius of Gyration

ALLOWABLE COLUMN LOADS (LBS)

Catalog No.	12"	18"	24"	30"	36"	42"	48"	60"	72"	84"	96"	108"	120"
H-179	1,246	1,010	777	600	493	419	364	-	-	-	-	-	-

ALLOWABLE BEAM LOADS (LBS)

Catalog No.	12"	18"	24"	30"	36"	42"	48"	60"	72"	84"	96"	108"	120"	
H-179	330	220	165	132	110	94	83	66	55	47	41	37	33	1
	-	-	150	96	67	49	38	24	17	12	9	7	6	2
	0.027	0.062	0.110	0.171	0.247	0.336	0.439	0.685	0.987	1.344	1.755	2.221	2.742	3

Allowable Uniform Beam Load based on calculations using 25000 psi Stress. **1**

Allowable Uniform Load at Maximum Deflection = L/240 of Span. **2**

Beam Deflection in inch, @ 25000 psi. **3**

Project Information		
Project:		Notes:
Address:		
Contractor:		
Engineer:	Date:	
Approval		
<input type="checkbox"/> Approved <input type="checkbox"/> Approved as Noted <input type="checkbox"/> Not Approved	Signature:	Remarks: