

T-617

Bracket
Wt. 226#/C

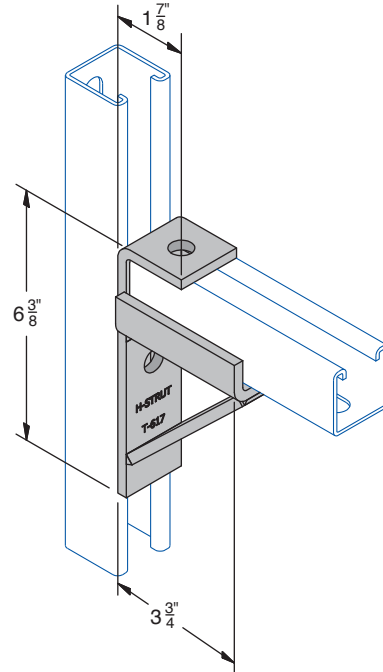

Use with:

- 1 5/8" x 1 5/8" 12-ga. Channel – H-132
- 1 5/8" x 1 5/8" 14-ga. Channel – H-134

SPECIFICATIONS

GENERAL

Brackets are designed to support pipe or conduit either suspended from threaded rod or supported as a cantilever from the wall. Note: These brackets can also be used in conjunction with electrical fittings.

MATERIAL

H-STRUT Hanging Supports are produced from our standard channels.

- ☐ Hot Rolled Steel SheetASTM A-1101 or Cold Rolled Steel SheetASTM A-1008
- ☐ Stainless Steel-Type 304/316. . .ASTM A-240
- ☐ Aluminum.ASTM B-221

FINISH

H-STRUT brackets are available in the following finishes:

- ☐ Electro-GalvanizedASTM B-633
- ☐ Hot Dipped Galvanized.ASTM A-123
- ☐ Zinc Trivalent ChromiumASTM B-633-85
- ☐ Powder Coated Supr-Green . . .ASTM B-117
- ☐ PVC Coating - Available Upon Request

ORDERING

Specify catalog number, length and finish.

Fittings Notes:

Holes are 9/16" diameter, spaced 1 7/8" on center and 1 3/16" from end.

Project Information		
Project:		Notes:
Address:		
Contractor:		
Engineer:	Date:	
Approval		
<input type="checkbox"/> Approved	Signature:	Remarks:
<input type="checkbox"/> Approved as Noted		
<input type="checkbox"/> Not Approved		