

Concrete Inserts & Accessories

Secure Form Before Concrete Is Poured

Concrete Inserts are designed for the attachment or suspension of framing, piping or equipment to concrete structures where a continuous insert slot is required. Continuous Concrete Inserts are nailed to the forms through the knockout holes provided in the closure cap.

APPLICATIONS

- Foam insert or plastic closure used to keep wet concrete out of channel.
- Used in pre-cast, pre-stressed or poured in place on concrete floors, walls & ceilings.
- Excellent support system for pipe, conduit, bridges and tunnels, also can be used in walls for bracing, brackets and pipe racks.

MATERIAL

Hot Rolled Carbon Steel.....ASTM A-1011-04-SS
Cold Rolled Carbon Steel.....ASTM A-1008
Stainless Steel (Type 304/316L)...ASTM A-240

BENEFITS

- Reliable load bearing capability
- Reduces labor cost
- Safer, no overhead drilling necessary when our systems are pre-assembled in ceiling concrete pre-cast beams
- Increases project flexibility
- Custom cut lengths for any job

FINISHES

Pre-Galvanized.....ASTM A-653-G90
Hot Dipped Galvanized.....ASTM A-123
Electro Galvanized.....ASTM B-633



Concrete Inserts & Accessories

Secure Form Before Concrete Is Poured

CONTINUOUS CONCRETE INSERTS

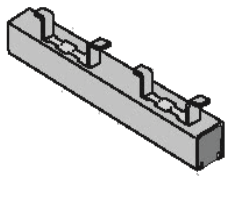

H-132-IN

12 Gauge Channel
1-5/8" x 1-5/8"

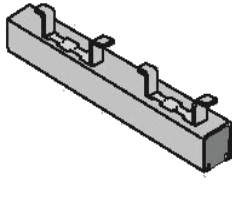

H-142-IN

12 Gauge Channel
1-3/8" x 1-5/8"

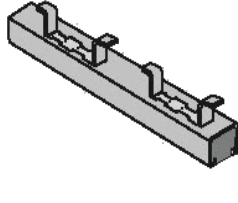

H-152-IN

12 Gauge Channel
1" x 1-5/8"

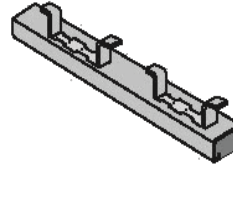

H-164-IN

14 Gauge Channel
13/16" x 1-5/8"

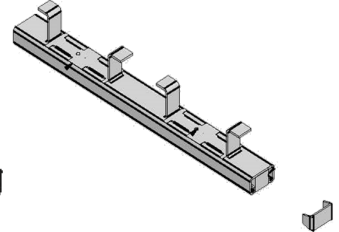

H-172-IN

12 Gauge Channel
7/8" x 1-5/8"

All inserts come with foam or plastic enclosure with end caps installed to prevent seepage.
Available in 10- and 20-foot lengths. Custom cut lengths for any job application available upon request.

ACCESSORIES

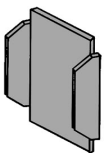

**1000
Series**
End Cap

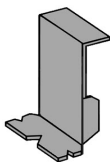

**1001
Series**
End Cap

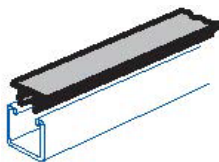

C-900P
Plastic Closure Strip

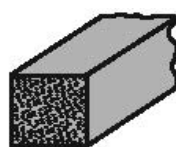

Styrofoam
Filler

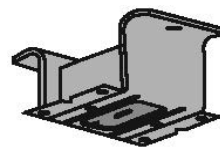

H-1200
Spot Insert



N-1200
Square Nut For Spot Insert